

Kalmar DRT450

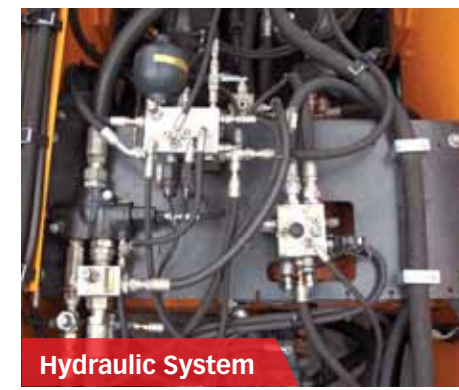



Hydraulic System



Engine Compartment



Easy maintenance

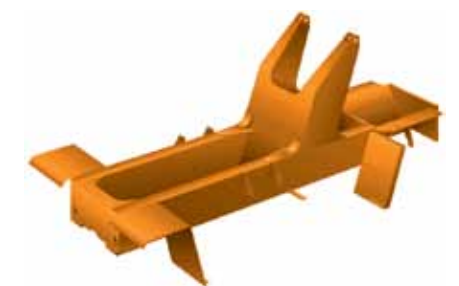

Chassis



Cabin & Control

Innovation based on experience

Cargotec launched its first Kalmar Reachstacker in 1985, since then more than 6.000 Reachstackers has been produced. The long experience and expert knowledge makes Kalmar the obvious choice when it comes to Reachstackers.

Container handling with a Kalmar DRT Reachstacker is one of the most flexible handling solutions whether you operate in a small one-unit terminal or a medium sized port. The Reachstacker can handle loaded containers quickly and efficiently in narrow spaces, while still ensuring that the driver has optimum visibility.

The Kalmar DRT Reachstacker has been developed to meet different customer needs. The Kalmar DRT offers a safe container handling with a high level of cost efficiency together with the renowned Kalmar quality.

Reliability at its highest

The durable and robust design offers long-lasting dependability, while the proven components keep you up and running at full efficiency. The hydraulic system with variable displacement pumps contributes to less heat build-up, extending the lifetime of all hydraulic components. The hydraulic system is equipped with oil cooler and can cope even in the toughest ambient conditions.

Low operation costs

It is very important that your machine is operational and productive as much of the time as possible, without unexpected stoppages. With Kalmar you get a machine that you can always trust.

A more efficient engine means low fuel costs. And effective filtering of the hydraulic oil means lower costs for oil changes.

Efficient driving thanks to high maneuverability can also reduce the consumption. All of which helps keeping the running costs low. This is just a couple of examples of why the Kalmar DRT will lower your operation costs.

Safety

A skilled driver becomes one with his machine. He learns to maneuver it down to the nearest millimeter. The improved visibility together with the ergonomically designed driver environment keeps the driver alert at all time. The instrument panel is placed readily visible in the field of vision, where the driver immediately can see if anything needs to be corrected.

Quality

The Reachstacker is our most tried and tested machine ever. No other Kalmar product has gone through as many and tough tests as the Reachstacker.

Proven and established technology

The DRT Reachstacker is built on proven components and technology that have been used in Kalmar machines for several years. All components have been carefully selected and tested in the toughest of environments to meet our high quality demands. In the environment where Reachstackers work there is simply not room anything but perfection.

Troubleshooting the easy way

With ease of service in mind, DRT has been designed with as few maintenance points as practical and a robust design in such areas as the chassis, boom, steering axle and spreader. Further troubleshooting is backed up with user-friendly documentation, making the life of the maintenance crew easier.

Global presence and local service bring
our products and solutions closer to our customer.



Cargotec improves the efficiency of cargo flows on land and at sea – wherever cargo is on the move
Cargotec's daughter brands Hiab, Kalmar and MacGregor are recognised leaders in cargo and load handling
solutions around the world. Cargotec's global network is positioned close to customers and offers extensive
services that ensure the continuous, reliable and sustainable performance of equipment.
Cargotec's class B shares are quoted on the NASDAQ OMX Helsinki. www.cargotec.com



Cargotec Hong Kong
Tel: 852-2944 8383

Cargotec North China
Tel: 86-21-5866 6658

Cargotec South China
Tel: 86-755-2685 6700

Cargotec Southeast Asia
Tel: 65-6597 3888

www.cargotec.com